



LIVESTREAM

cloud video streaming

DW/S/ON

CLOUD VIDEO STREAMING

With the use of **QTAKE HD** video assist system and cloud video streaming platforms such as **QTAKE CLOUD STREAM** or **YouTubeLive** we are able to stream live image from set to clients and directors across the local network and the Globe simultaneously, in real time.



WHAT IS QTAKE HD?

QTAKE HD video assist system is the most advanced software designed and developed for professional video playback. It is used to log, capture, playback, edit and process video output and RAW recording of the digital cinema cameras. The main purpose of any video assist system is to provide immediate playback for the crew, but QTAKE goes far beyond that. It provides unique database customisable to fit any project, realtime image processing up to 8K resolution, multi-camera support, on-set colour grading, live editing and much more.

The ability to capture metadata from camera and other on-set devices makes QTAKE HD a key part of any advanced cloud streaming workflow which is the reason we use it on set as our base video system, combined with cloud streaming platform of choice.

CLOUD STREAMING PLATFORM OPTIONS

QTAKE CLOUD STREAM vs YOUTUBE LIVE

WE OFFER TWO SETUPS OF CLOUD STREAMING, DEPENDING ON PREFERRED FINAL OUTPUT:

- 1) **QTAKE HD** in combination with **QTAKE CLOUD STREAM** real-time streaming
- output for viewer is QTAKE MONITOR APP via private link and authentication
- 2) **QTAKE HD** in combination with **YouTubeLive** real-time streaming
- output for viewer is YouTube website via private link & login

In both cases QTAKE HD video assist serves as our main playback system on set for the best possible image manipulation during the shoot. Depending on selected output option above the video is exported and streamed live over corresponding cloud server.

QTAKE CLOUD STREAM TECH SPECS

- Using the QTAKE STREAM Module, we are able to stream the content of on-set QTAKE HD camera views to iPads or iPhones in the local network. Very low latency of just 1.5 frames makes QTAKE MONITOR local devices practically in sync with QTAKE GPU Output
- QTAKE CLOUD extends the functionality of the QTAKE STREAM module to reach past the local network to anywhere in the World, over a secure, encrypted connection
- QTAKE MONITOR APP simply turns all Apple platforms (iOS, macOS, tvOS) into “on-set” HD monitors. Each viewer can setup his view as per his liking (full screen, dual, 4 - views)
- Streaming of up to 4 cameras with metadata is possible from a single QTAKE system
- Requires strong / high bandwidth internet connection
- Latency: 0.5 - 2 seconds
- Security: private link, user authentication & confirmation
- Compatibility: App for iPad, iPhone, Apple TV and Mac. Does not support MS Windows

YouTubeLive TECH SPECS

- Simple and reliable way to reach any audience globally in real time via any web browser on any device with internet connection and access to YouTubeLive website
- HD streaming resolution or higher (4k) resolutions depending on project needs
- Viewers are able to interact with each other in real time during the streaming and exchange comments as well as provide feedback in the standard built-in chat provided by YouTube below the video window.
- Viewers are able to scroll back on the video timeline and re-watch the footage effortlessly and independently on their own device so no need for QTAKE operator on set to repeat playback each time someone wants to re-watch some footage. Video stream can also easily be saved and watched later.
- Requires weaker internet connection on set / less bandwidth compared to QTAKE CLOUD STREAM which makes it good for location shoots
- Latency: 6-20 seconds, depending on location and internet connection
- Security: registration, user authentication, private link
- Compatibility: Supports all modern browsers all modern OS and all modern TVs

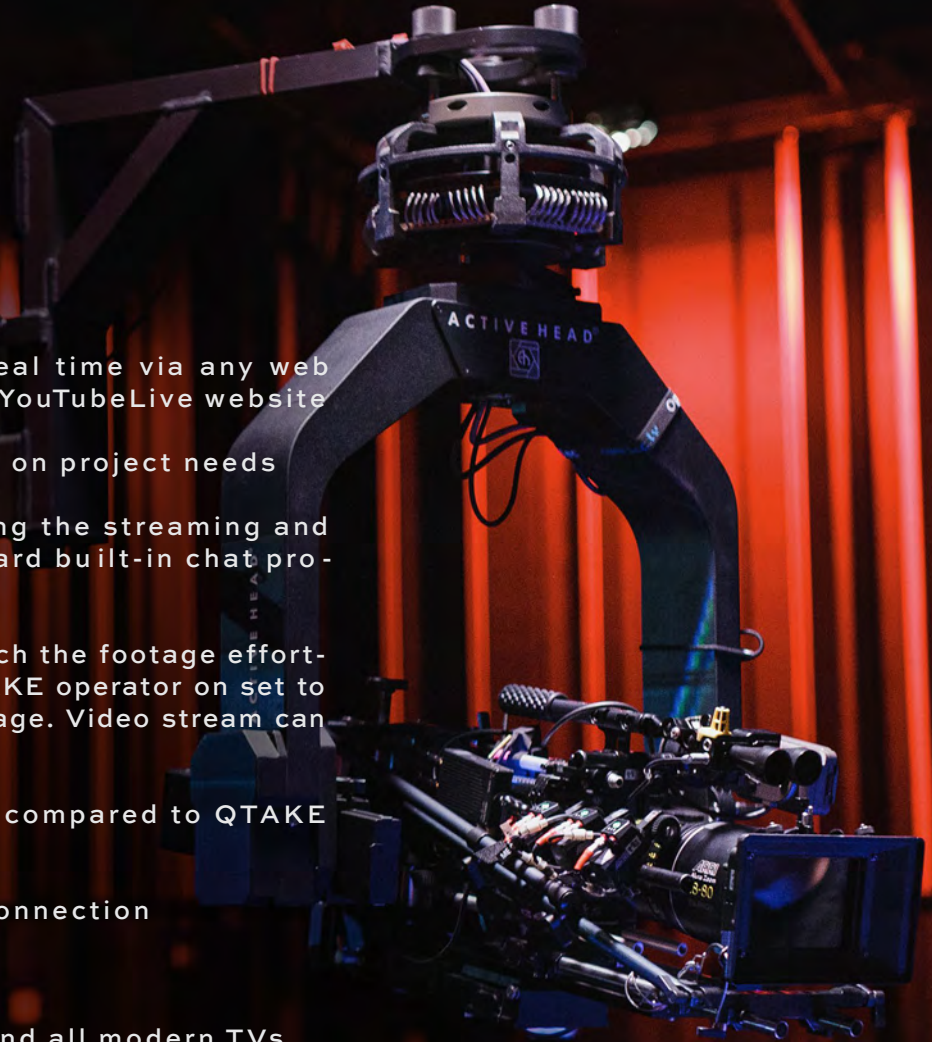



LIVE COMMUNICATION DURING SHOOT

Beside the selected CLOUD STREAMING PLATFORM for live camera views additional live communication channels such as **Zoom**, **Skype**, **FaceTime**, etc. are recommended for live video chat with selected crew, agency, client. These are set up independently of the CLOUD STREAMING and are determined by client preference.

LIVESTREAM

cloud video streaming

LIVESTREAM does not interfere with workflow on set!

LIVESTREAM depends a lot on fast and reliable internet connection!

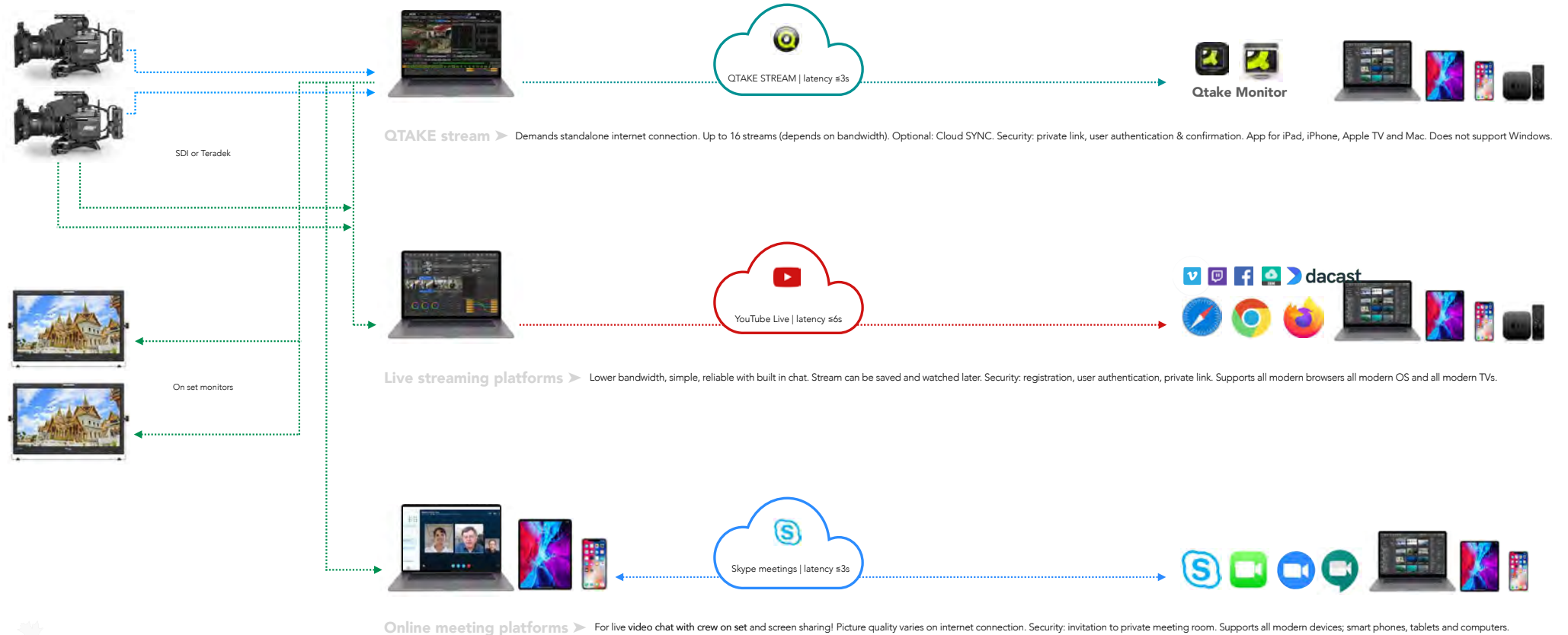

ENJOY THE SHOOT!

DIVISION

Gorkiceva ulica 7
1000 Ljubljana, Slovenia

www.division.film / info@division.film

Rok Bukovec / Executive Producer
rok@division.film / cell: +386 30 33 22 00